



Construction
Products Group
Europe

Modular Manufacturing

—
INNOVATIVE SOLUTIONS



A FAMILY OF BRANDS UNDER ONE ROOF

CPG Europe manufactures high performance building materials in order to solve the complex challenges faced by today's construction industry. With over 1,400 employees across Europe, we are committed to shaping a world where buildings and structures save energy, last longer and exceed sustainability benchmarks.

Our detailed understanding of our customers, their markets and the demands of the industries in which they operate, enables us to offer bespoke product and service packages for the complete building envelope.

Over recent years, CPG UK has recognised and responded to the construction sector's demands for more efficient construction techniques and processes. Off-site and Modern Methods of Construction are key ways in which this demand can be met.

With over 85 years experience within construction products, CPG Europe has created innovative and reliable solutions that meet the most stringent challenges of rapidly advancing modular manufacturing processes.

Working closely with our customers, we develop an understanding of their challenges and needs to offer a focused, innovative and tailor-made solution.

Europe's leading construction products brands...



- | | | |
|--|-----------------------------------|----------------------------|
| 1 Car Parking Structures | 6 Roofing Systems | 11 Fire Stopping |
| 2 Balconies, Podia & Terraces | 7 Façade Construction | 12 Intumescent Coatings |
| 3 Seamless Resin Flooring | 8 Structural & Inplant Glazing | 13 Basements & Foundations |
| 4 Window Installation | 9 Subfloor Preparation | |
| 5 Exterior Insulation & Finishing Systems (EIFS) | 10 Potable & Waste Water Industry | |

INNOVATIVE, FOCUSED ONE SOURCE SOLUTIONS

FOR MODULAR MANUFACTURING

Over recent years, CPG UK has recognised and responded to the construction sector's demand for more efficient construction techniques and processes.

Modular Manufacturing and Modern Methods of Construction are key ways in which this demand can be met.

With 85 years experience within sealing, bonding and building protection, CPG UK has created innovative and reliable solutions that meet the most stringent challenges of rapidly advancing modular manufacturing processes.

Working closely with our customers to

understand their developing needs is a critical part of meeting these challenges, and ensures that CPG UK is able to offer focused innovation, bringing added value to our tailor-made solutions.

The broad spectrum of products available through our key brands - TREMCO, illbruck, Nullifire, Dryvit & Flowcrete - offers product solutions from one manufacturing source for almost all applications. This means the simplicity of short supply routes for our customers, products that work together from one accountable manufacturer and construction solutions that, simply, work better and harder for you.

FLOORS

PAGE 08-09

INTERNAL WALLS

PAGE 10-11

FZ100 SAFZEONE

PAGE 12-13

EXTERNAL WALLS

PAGE 14-15

MODULE JOINTS

PAGE 16-17

BATHROOM PODS & FIT OUT

PAGE 18-19

OTHER SOLUTIONS

PAGE 20-22

WHY USE CPG?



Reliability

Reliability through strong product brands.



Efficiency

Efficient systems for industrial and onsite applications.



Single Point of Contact

One contact for our 6 brands covering a wide array of application areas.



Technical Support

Technical and sales advice for every situation across Europe.



Training & Workshops

Pioneering Training Courses & Seminars.



Local Manufacturing & Supply

23 European locations for quick access to our products.

Caledonian Modular: Case Study

CPG UK performed a free assessment for Caledonian Modular. Analysing their processes across all facilities (3 sites), we found them to be using nearly 50 products from a large number of suppliers, with all the supply chain and compatibility issues that entailed.

This was rationalised down to 17 products - all from CPG UK - meaning less waste, fewer admin processes and a one-link supply chain that was fully accountable for all issues.

"CPG UK carried out production line audits in all locations free of charge, to identify our current products and processes, and also to confirm and clarify the applications in which they were used.

The proposal from CPG UK allowed us to greatly rationalise the number of products in use from 47 to 17, and suppliers from 20 to 1 which had enormous benefits to our organisation in terms of commercial, production, quality traceability, and administrative cost savings."

Mark Wright, Purchasing Manager: Caledonian Modular

MODULAR MANUFACTURING

SOLUTIONS DRIVEN FOR YOU

In an increasingly complex sector, strong price competition, sustainability and safety requirements make the appetite for more efficient and productive methods of construction ever greater.

Modular manufacturing can deliver substantial design, manufacturing, scheduling and safety benefits across the construction sector. Its unparalleled advantages have led to the significant increase of building elements and modules constructed offsite in the UK over the last few years.

The modular manufacturing sector uses technology and construction methods that are well established and that have been proven throughout Europe to increase productivity, maximise safety and deliver more efficient and sustainable buildings.

SCAN THE QR CODE TO EXPLORE OUR SOLUTIONS



COLLABORATIVE PARTNERSHIPS

CPG UK has the technical expertise, the dedicated service levels and the product range to provide bespoke solutions for sealing, bonding, air and weather tightness, fire resistance and acoustic performance for a wide range of offsite constructed modules, pods and other off-site building elements.

Product Range

Our product range is unique, in terms of its performance levels, its range of application and its extent.

Equally unique is the inter-compatibility of our range: this extends from adhesive to tape, to membrane, to fire resistant foam.

Our products, designed, manufactured and tested to work together, eliminate compatibility issues in the factory and further streamline off and onsite construction processes.

Bulk Products

At CPG UK we promote the use of higher volume packs. 600ml or higher packaging

formats allow considerable economies in cost, increase speed of application and reduce both product and packaging waste.

Service

Our full range of services are centred around providing bespoke solutions to specific modular manufacturing requirements.

Trade Associations

We are members of the Modular and Portable Building Association and the Structural Timber Association.



modular & portable
building association



STRUCTURAL
TIMBER ASSOCIATION



FLOORS

CPG UK offers a range of internal floor solutions to suit a variety of build up options. This includes adhesives for board joint details - whether combined with traditional mechanical fix or totally bonded options - along with acoustic tapes, smoothing compound and floor adhesives.

These intergrated and flexible product systems offer faster build times through reduction or removal of mechanical fix, enhanced acoustic and thermal properties, and perfectly smooth, permanently bonded floors.

- No floor movement or floor noise
- Cushioning underfoot
- Reduction or elimination of mechanical fix
- Perfectly smooth uninterrupted floor finish

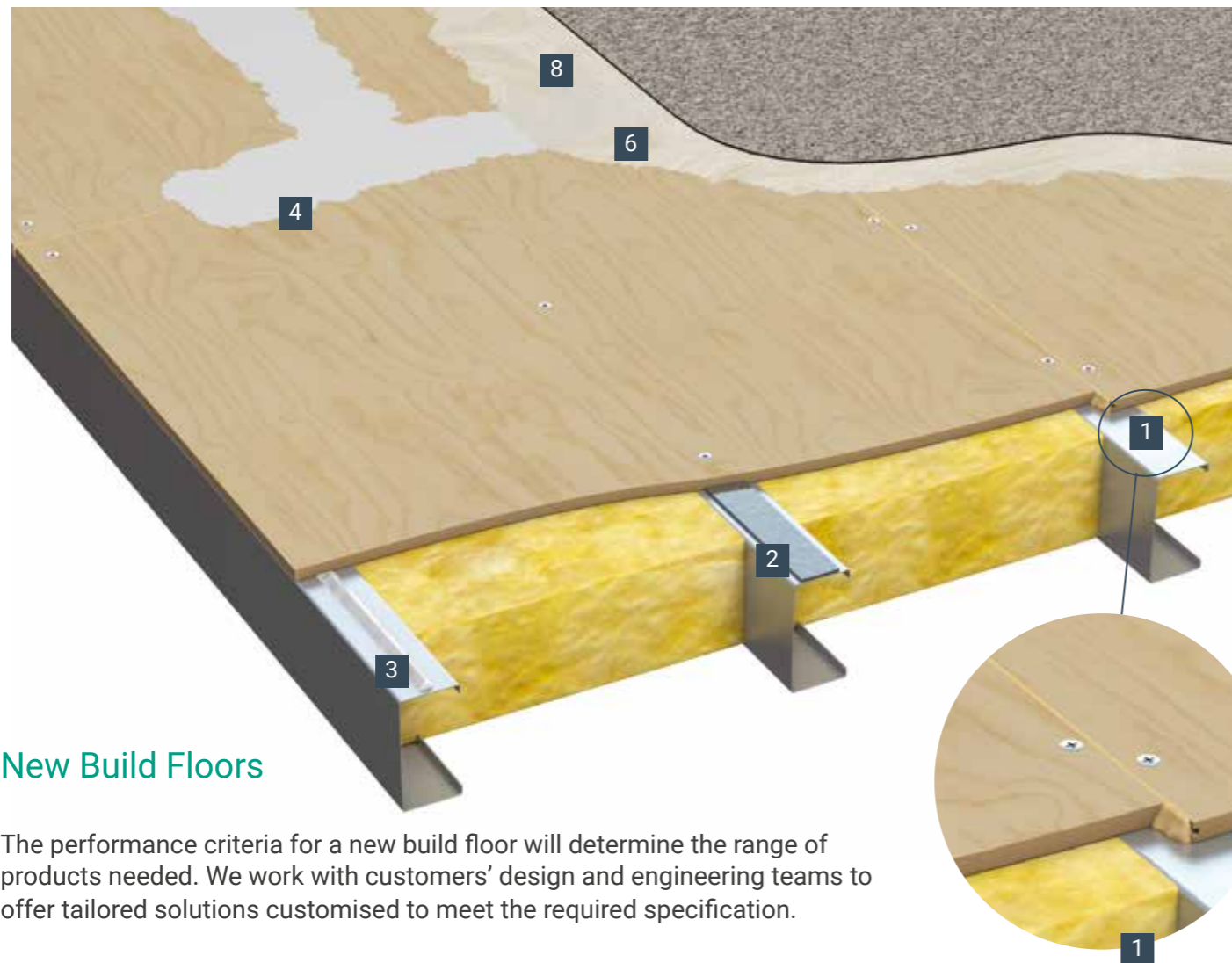

New Build Floors

The performance criteria for a new build floor will determine the range of products needed. We work with customers' design and engineering teams to offer tailored solutions customised to meet the required specification.

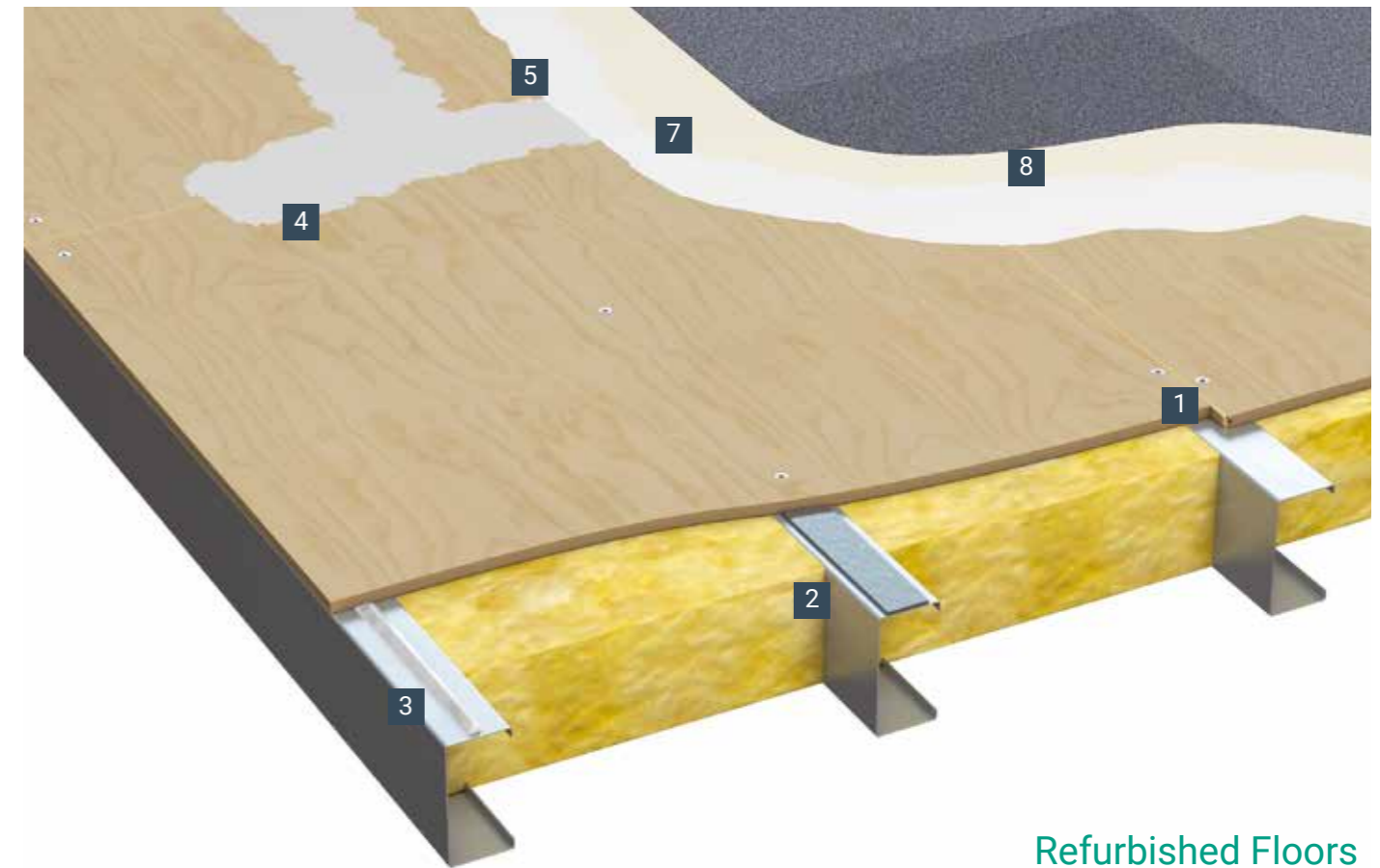

Refurbished Floors

The re-use of existing timber floor panels in refurbishment projects can be facilitated by the use of TREMCO smoothing compounds. These are complemented by a range of adhesives that are recommended by key floor covering manufacturers.

Window to wall interface detail

The illustrations below highlight commonly used CPG UK products, but are by no means exhaustive. Many other products are available to meet differing application and performance criteria.

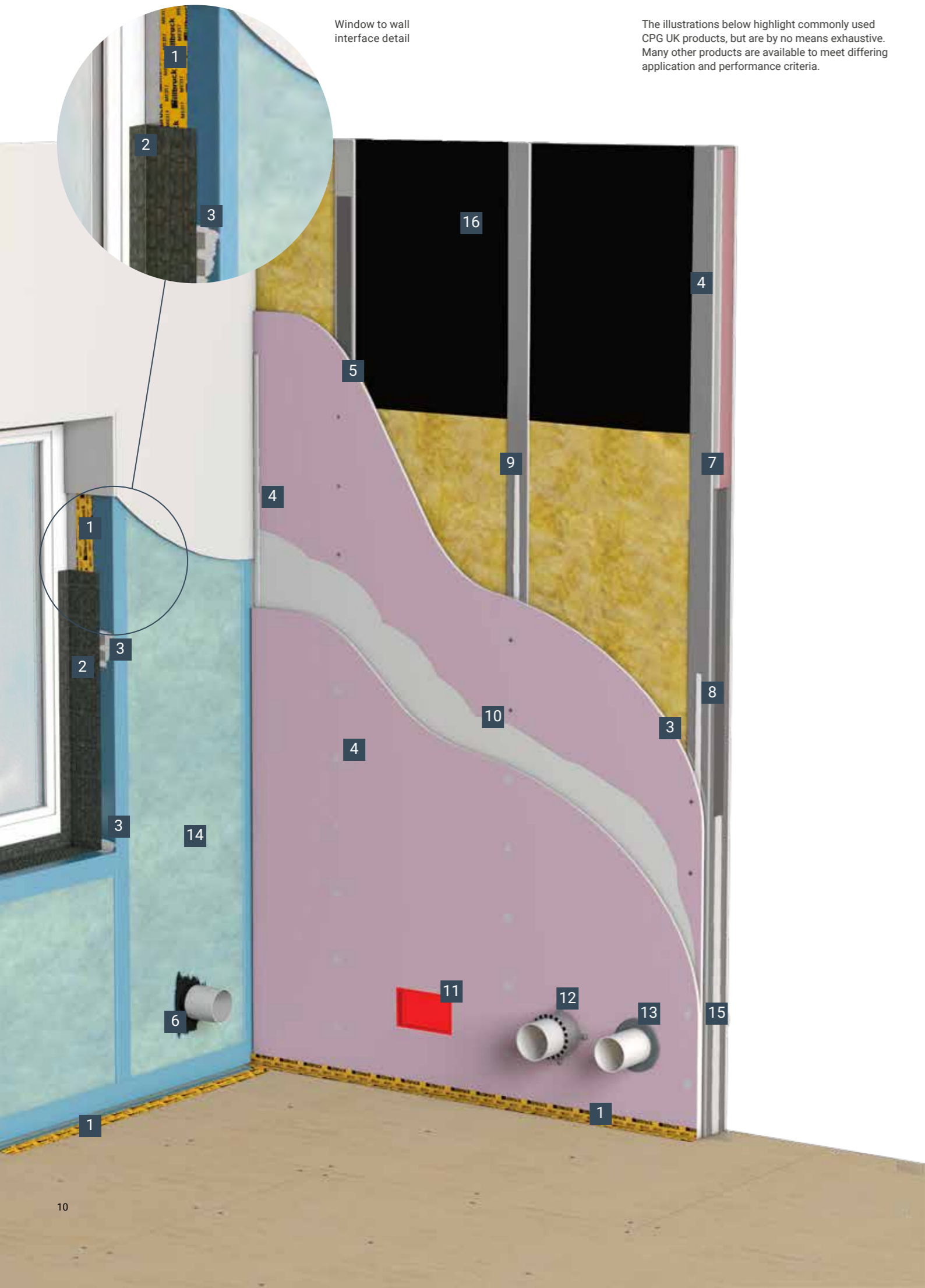

INTERNAL WALLS

Our bonding, sealing and fire stopping products are used extensively in internal wall construction, offering structural benefits, acoustic and thermal breaks, and module and junction detail sealing options.

Our comprehensive range and focused innovation allows various product options to suit individual application needs, ensuring the most robust, and fabrication-friendly options are selected.

Vapour tight walls are created using our high performance, lightweight and cost effective vapour barrier, sealed along its edges with adhesive and tapes.

The range is complemented by a full suite of adhesives and primers to effectively seal the vapour barrier to the structure.







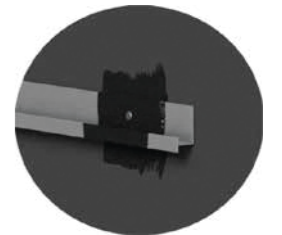

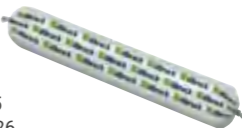

Additionally, our window membranes ensure the micro areas around the window are properly sealed.

Finally, penetrations can be sealed using our unique brushable illbruck SP925 sealant.

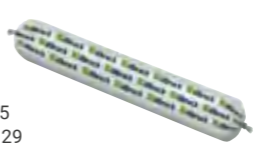
- Airtightness
- Controlled vapour permeability
- Elimination of cold bridging
- Sealing and bonding
- Fire stopping and acoustics



Complex small joints and penetrations from brackets and fixings can be sealed using our unique, brushable sealant - illbruck SP925 - to provide a complete airtight and moisture management solution.

<p>1</p>  <p>ME317 Page 25</p>	<p>2</p>  <p>ME508 Page 25</p>	<p>3</p>  <p>SP925 Page 26</p>	<p>4</p>  <p>FS702 Page 29</p>
<p>5</p>  <p>TN119 Page 25</p>	<p>6</p>  <p>SP925 Page 27</p>	<p>7</p>  <p>FF197 Page 28</p>	<p>8</p>  <p>FJ400 Page 28</p>
<p>9</p>  <p>MT480 Page 25</p>	<p>10</p>  <p>WD120 Page 27</p>	<p>11</p>  <p>FO100 Page 28</p>	<p>12</p>  <p>FP170, FP220 & FP302 Page 28 & 29</p>
<p>13</p>  <p>FS709 & FS719 Page 29</p>	<p>14</p>  <p>ME003 & LD925 Page 24 & 25</p>	<p>15</p>  <p>FS703 Page 29</p>	<p>16</p>  <p>FZ100 Page 23</p>

AN INTRODUCTION TO FZ100 FIRE SAFE ZONE

FZ100 Fire Safe Zone is a revolutionary fire protection system, and a single product solution tested to cover many fire stopping requirements.

Nullfire has developed a ground-breaking and unique fire stopping technology: GXT (Graphite, eXpansion Technology). Incorporated within FZ100 Fire Safe Zone, GXT technology, removes the need for multiple fire protection products within a single partition.

FZ100 is typically installed during the construction phase. One side of the partition may be fully installed prior to the application of FZ100. This technology should be compressed between two vertical studs at the expected service locations, the partition should be closed with the required plasterboard and the area should be identified with the "Fire Safe Zone" tape.

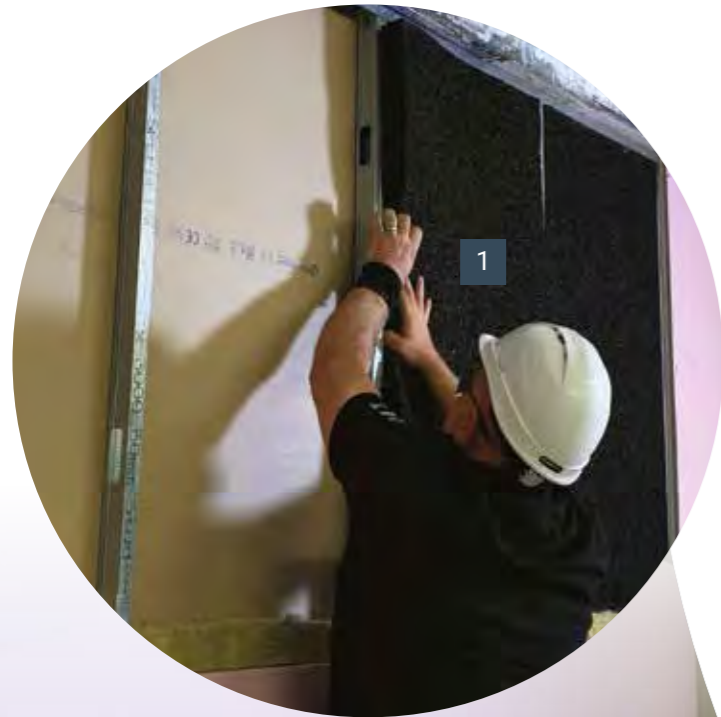

Product Benefits Summary:

- Allows both instant & future protection
- Quick and easy to install: clean, dry, easy to cut, lightweight
- Simple service installation
- Very low odour, low tack
- Service movement capable by design
- Does not detract from the acoustic capabilities of the partition
- Fully breathable, does not absorb moisture
- Tested to BS EN 1366-3, up to EI120

See application instructions for more information on FZ100

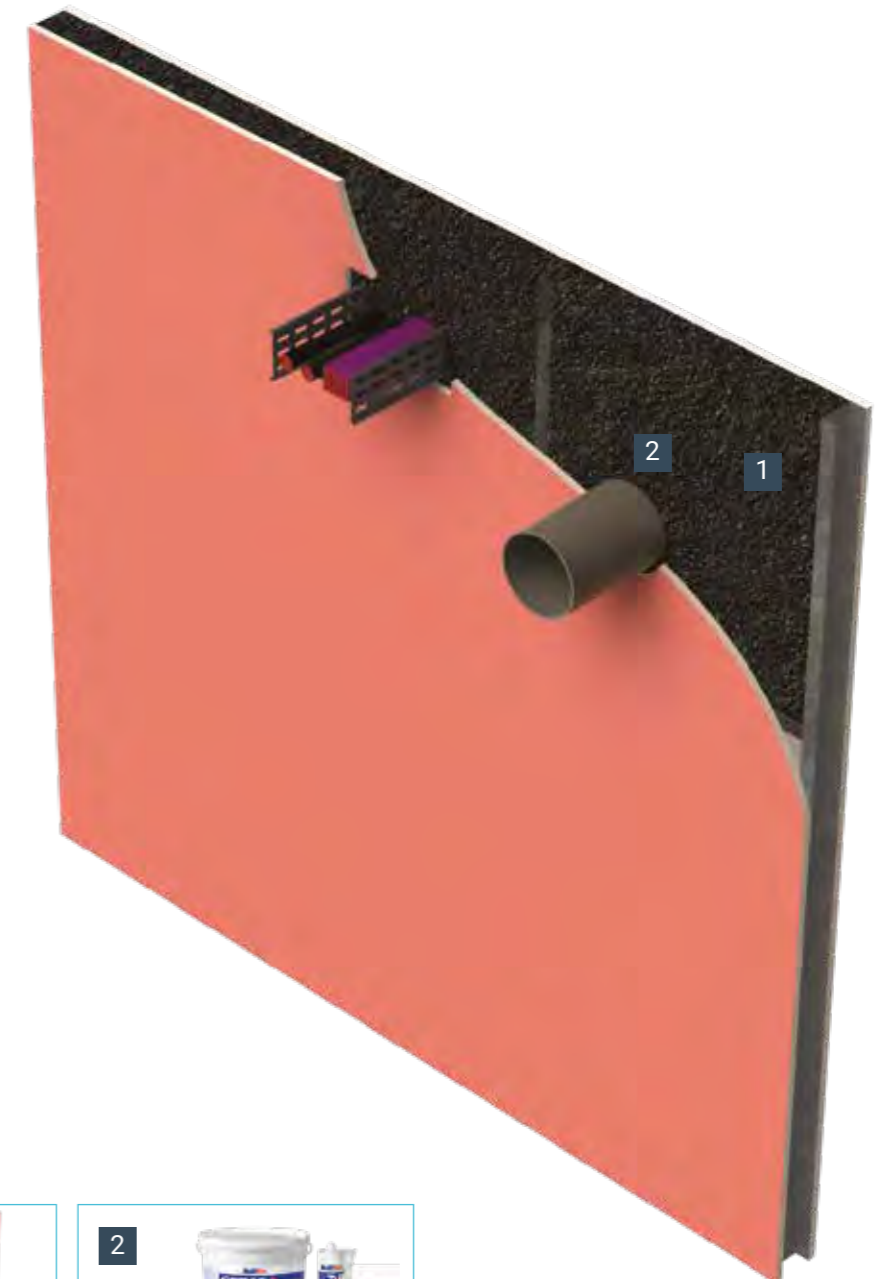

Why Use FZ100 Safe Zone?

- Simple to Install
- 5 Times Faster
- A Multi-Compliant Solution
- Eliminate Waste Expenditure

Key Benefits Summary:

- No need to frame and line
- No need to cut and prepare batts
- No need for multiple closure devices
- No need for repetition of work

SCAN THE QR CODE FOR
MORE INFORMATION



EXTERNAL WALLS

Windows and Sheathing

The main image, right, shows how each building element is sealed to create an airtight and vapour-open construction. This is achieved with the illbruck Building Protection Range of fully compatible adhesives, tapes and membranes.

The high performance breather membrane is fully airtight yet vapour-open, unlike many on the market. This allows flexibility and peace of mind with the window membrane interface.

- Full weather proofing
- Airtightness
- Controlled vapour permeability
- Elimination of cold bridging

ME315 in Detail

- Provides instant, temporary waterproofing
- Can be used in damp conditions
- Offers 12 months UV stability
- Available in a range of sizes



Cladding and Trims

illbruck impregnated and laminated tapes offer excellent solutions for creating flexible yet long lasting external weather seals.

The composition of these products allows them to conform to panel contours and provides an effective seal to substrates that will be subject to movement during transportation, or through general expansion and contraction once installed.

Our hybrid polymer adhesive technologies also provide combined bonding and sealing options for external trims, offering enhanced aesthetics.

- Flexible, long-lasting weather seals
- Seals adapt to contoured and profiled panels
- Seals accommodate movement, expansion and contraction.

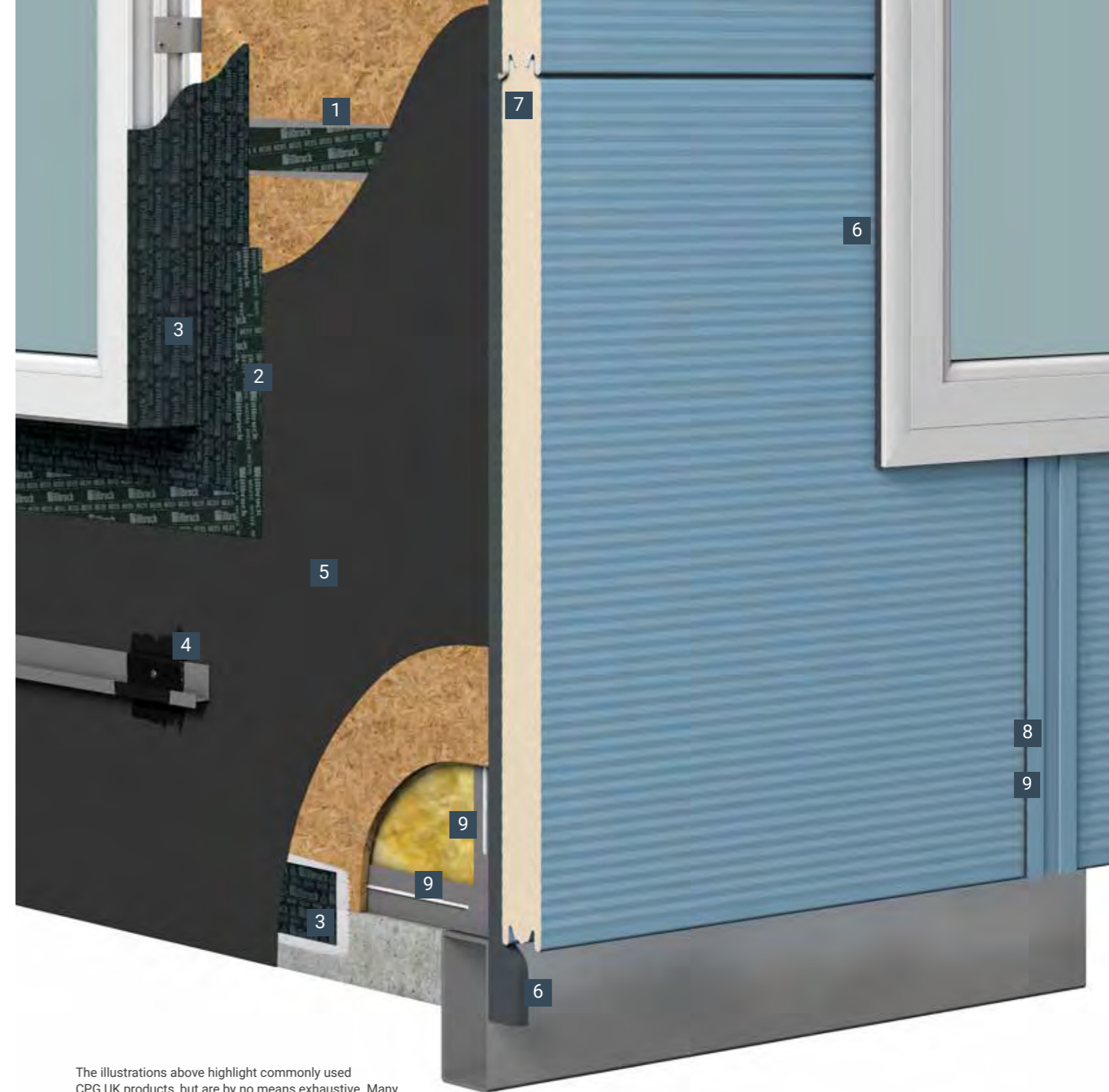

<p>1</p>  <p>ME904 Page 25</p>	<p>2</p>  <p>ME315 Page 23</p>	<p>3</p>  <p>ME501 VV Page 25</p>	<p>4</p>  <p>SP925 Page 26</p>
<p>5</p>  <p>ME009 Page 24</p>	<p>5</p>  <p>ME011 & ME010 Page 24</p>	<p>6</p>  <p>TP600 Page 27</p>	<p>7</p>  <p>FA600 Page 23</p>
<p>8</p>  <p>TN553 Page 27</p>	<p>9</p>  <p>SP150 Page 26</p>		

The illustrations above highlight commonly used CPG UK products, but are by no means exhaustive. Many other products are available to meet differing application and performance criteria.

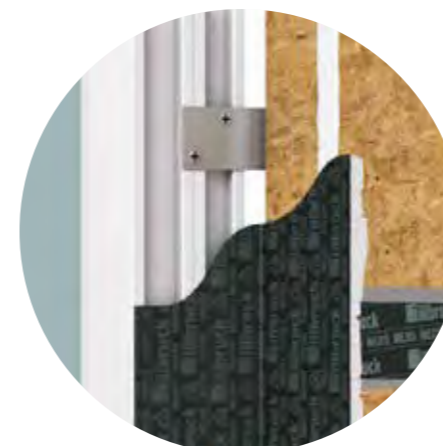

Projecting Window

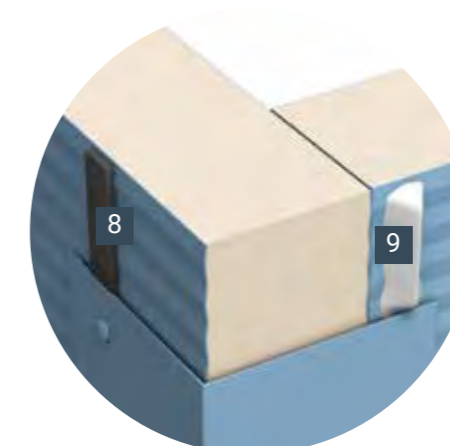

Options for fixing and sealing of trims



illbruck TP600 adapts to panel profile to provide complete UV and weather seal

MODULE JOINTS

The sealing and weatherproofing, as well as the fire protection of module joints is critical, and can be costly should failures occur. CPG UK's portfolios of tapes, sealants and waterproofing technologies offer many options to create robust junction details, along with acoustic and fire performance options.

Solutions can be designed and tested at our in-house facilities to meet specific project and/or manufacturing process requirements.

- Increased modular manufacturing scope
- Excellent accommodation of movement
- UV stability
- Elimination of cold bridging

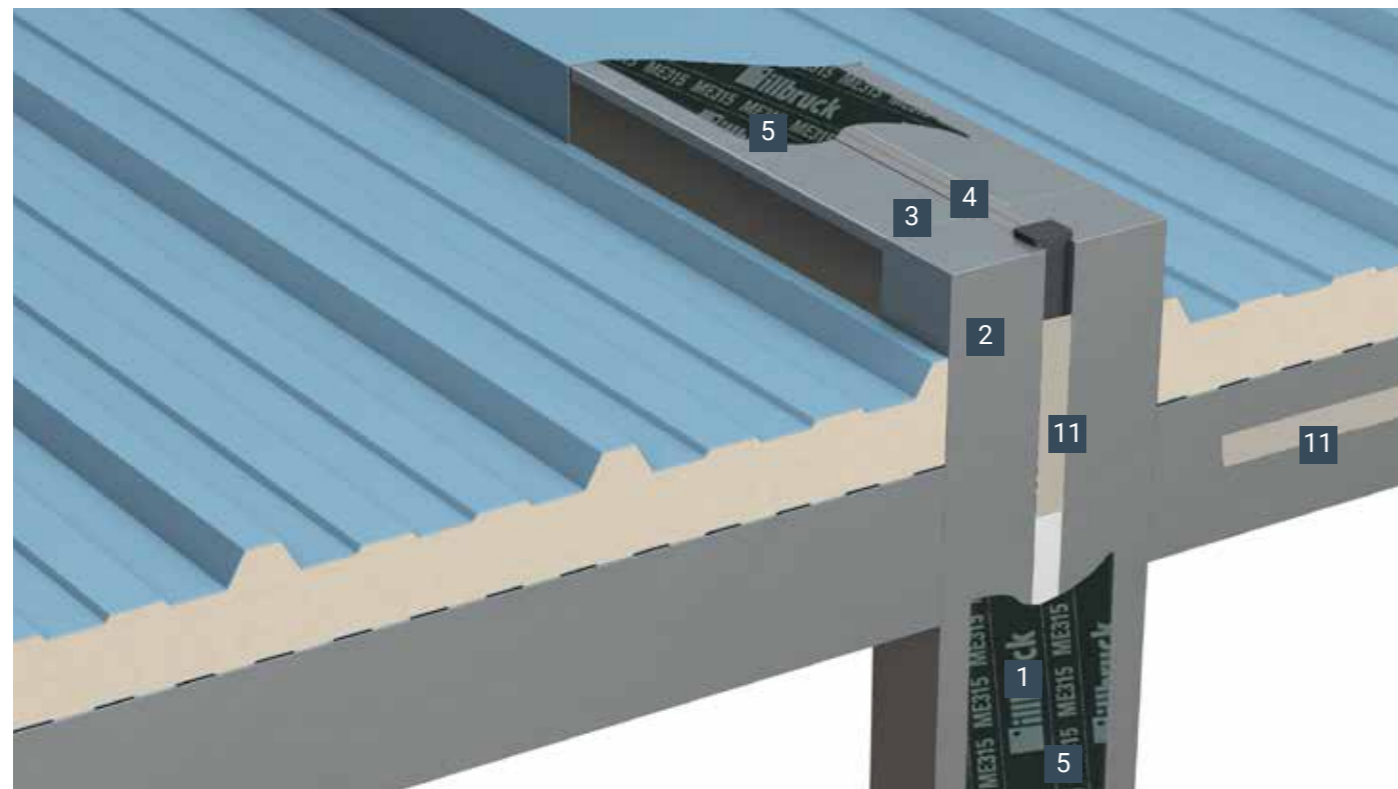

Module Joint: Pitched Roof

Where tolerances are controllable, or minimal on site sealing is desirable, our laminated and/or encapsulated, impregnated tape systems can be pre-applied at factory build stage for compression or expansion during site installation.

Our sealant technologies offer excellent movement accommodation and UV stability for final sealing when required.



Module Joint: Temporary Waterproofing

Although project requirements vary greatly in terms of site conditions and application restrictions, using our cold applied liquid waterproofing systems in conjunction with our sealants and tape technologies, offers wide-ranging options for temporary and permanent weatherproofing solutions.

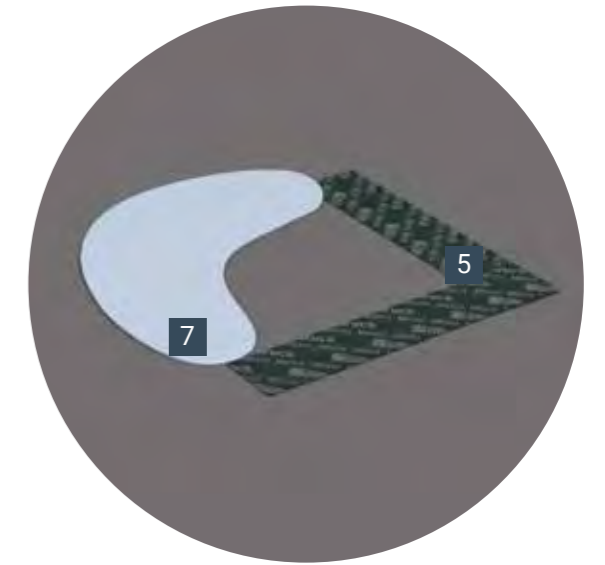

illbruck ME315 tape or cold applied liquid waterproofing can be used to fix tears in roof blankets

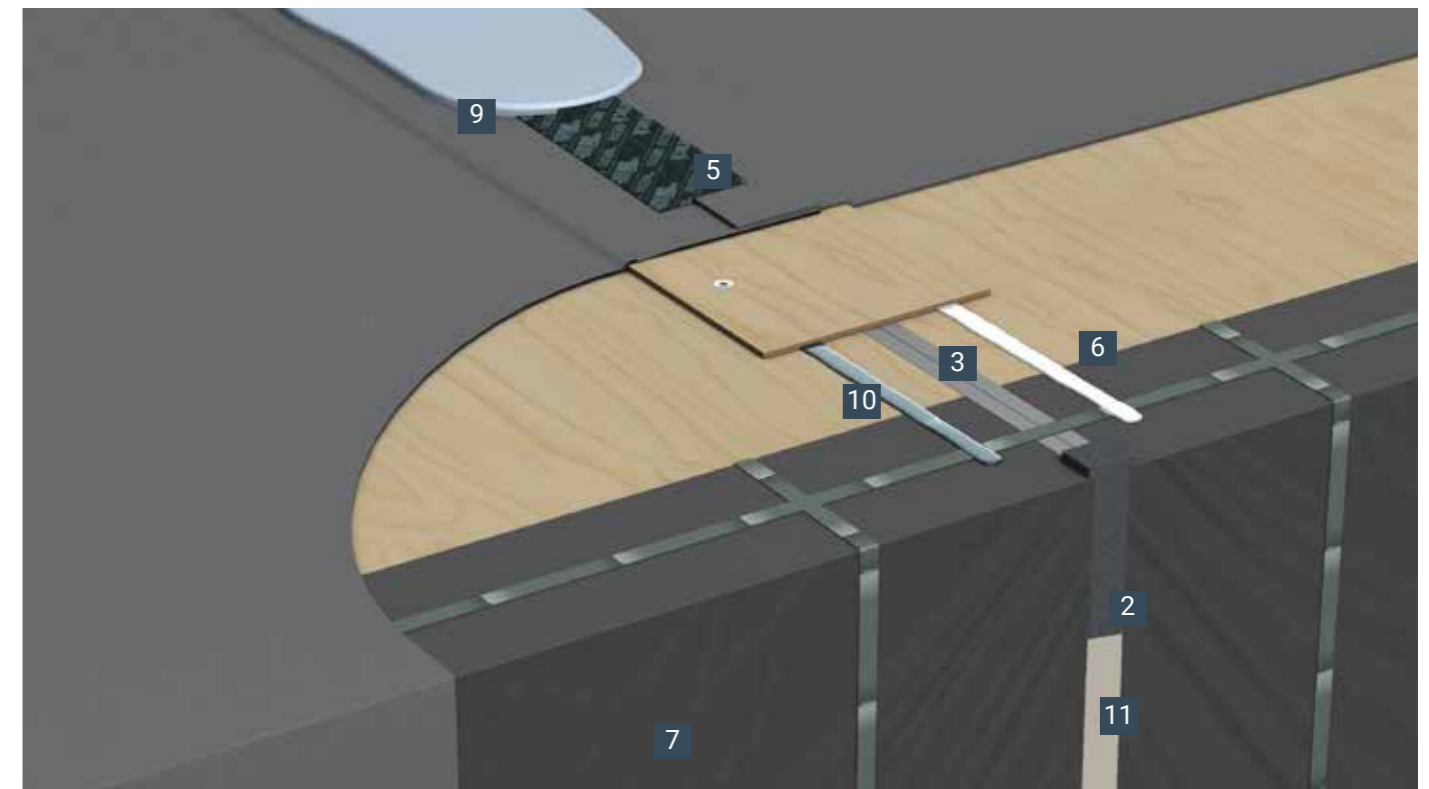

The illustrations above highlight commonly used CPG UK products, but are by no means exhaustive. Many other products are available to meet differing application and performance criteria.

BATHROOM PODS AND FIT OUT

Bathroom and kitchen pods require wide-ranging product solutions incorporating fire stopping, bonding and final sanitary sealing.

The CPG UK range can offer cross-compatible products for all applications from one manufacturer, which accelerates the manufacturing process and maximises production output.

- Up to 4 hours fire stopping
- Mirror bonding and sanitarywear sealing
- Good acoustic insulation, reduction of sound transfer
- Bonding of boards to framework

Steel Frame

Our hybrid polymer adhesives and sealants maintain bonds and seals during transportation and installation by accommodating movements and can reduce sound transfer in installed pods. Bonding of mirrors and trims can also improve aesthetics by removal of mechanical fixings.

Our Nullfire range provides a broad spectrum of fire stopping solutions including time and space saving options.

GRP Skin

Hybrid polymer adhesives offer high-grab bonding solutions across many fit-out applications, including mirror bonding and fixing of external timber support panels.



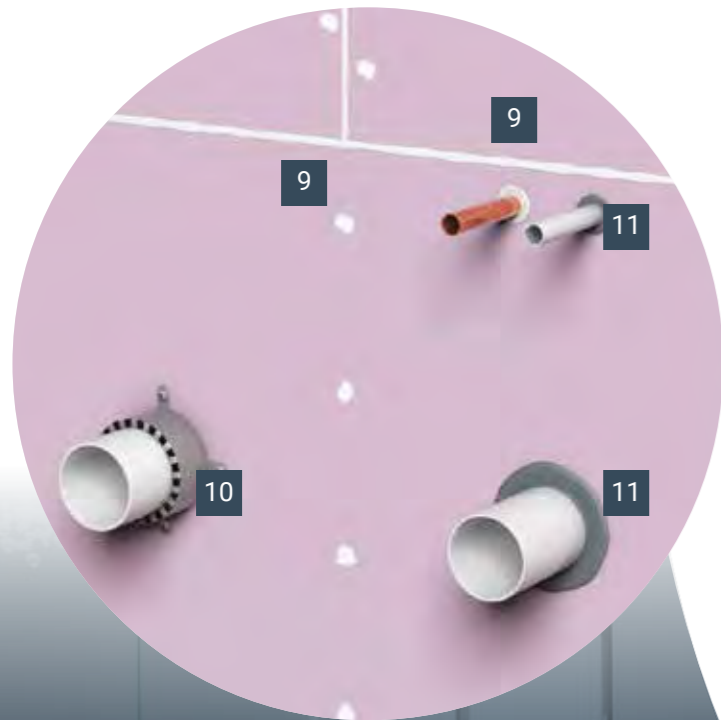





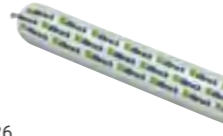

Our premium quality silicone ranges are suitable for use in bathroom and kitchen pod applications where a quality performance and aesthetic seal is required.



Waste and soil pipe detail options



The illustrations above highlight commonly used CPG UK products, but are by no means exhaustive. Many other products are available to meet differing application and performance criteria.

<p>1</p>  <p>MT480 Page 25</p>	<p>2</p>  <p>SP525 Page 26</p>	<p>3</p>  <p>SP510 Page 26</p>	<p>4</p>  <p>SP150/SP050 Page 26</p>
<p>5</p>  <p>FA600 Page 23</p>	<p>6</p>  <p>FO100 Page 28</p>	<p>7</p>  <p>SF165 Page 31</p>	<p>8</p>  <p>CY340 Page 24</p>
<p>9</p>  <p>FS702 Page 29</p>	<p>10</p>  <p>FP170, FP220 Page 28 & 29</p>	<p>11</p>  <p>FS709, FS719 Page 29</p>	<p>12</p>  <p>FZ100 Page 23</p>

PARK AND LEISURE

As build standards approach building regulation levels, CPG UK have the solutions to assist with air and weather tightness requirements for the park and leisure sector. Working closely with our customers, we develop optimised solutions that precisely suit their needs.

Weather sealing is critical in timber frame construction and our impregnated tapes offer excellent solutions for the profiled cladding systems commonly used.

Our high quality products offer opportunities for increased production throughput, along with high-end finishes in bathroom and kitchen applications.

- Improved production speeds - fast cure adhesive systems
- Adaptable weather sealing - impregnated tapes
- Airtight solutions - breathable and vapour membranes
- High quality fit-out products - silicone sealants, hybrid polymer adhesives and acrylic caulks



Image reproduced with kind permissions of Marley Eternit Ltd

TIMBER FRAME

This sector focuses on sustainable building and low waste processes, along with precision engineering, guaranteeing consistent quality.

Where timber frame manufacturers are providing structural kits or closed panel frames with insulation, internal wall linings, windows, doors and external claddings, the CPG UK product portfolio fits perfectly. We offer products for panel junctions, reduction of thermal bridging, better airtightness and improved thermal efficiency, simultaneously minimising waste.

- Airtightness
- Controlled vapour permeability
- Elimination of cold bridging
- Sealing, Bonding and Fire Stopping



EXPLORE OUR PRODUCT RANGE

As part of CPG UK, our product offering to modular manufacturing extends across our product portfolio. With access to products from illbruck, Nullifire and tremco - you are given a choice to identify the right product for your process.

We also offer a range of compatible accessories to support our products.

FA600 FRAME SILICONE

FA600 cures rapidly to form a permanently flexible and extremely durable watertight seal. For more information visit our website.

- Meets the requirements of ISO 11600-F&G-25LM
- Long-term resistance to weathering, ageing and UV
- Wide Service Temperature Range: -40°C to +150°C
- Neutral curing: compatible with sensitive substrates
- Contains fungicide to reduce mould growth



ME009 BREATHER MEMBRANE UV - WIDE FORMAT (3.2M)

ME009 is a highly breathable construction membrane that provides an effective waterproof layer for building facades. It is designed in a wide format making it ideal for use in modular manufacturing. For more information visit our website.

- UV resistant - 12 months UV stable
- W1 rating for resistance to water penetration
- Non-branded, plain black finish - suitable for visible applications
- Highly vapour open
- Airtight and Weathertight



ME315 TOTAL PROTECTION TAPE

ME315 is a single-sided adhesive tape for interior and exterior use, providing a high performing air and weather tight seal. Suitable for a wide variety of applications including sealing of sheathing boards, slab edge details and the durable bonding of illbruck vapour barrier and breather membranes. For more information visit our website.

- Fully compatible with all illbruck building protection products
- Interior and exterior use
- Quick and easy application
- Can be used with partially open facades
- Excellent adhesive bond strength to most common substrates



FZ100 FIRE SAFE ZONE

FZ100 is a revolutionary fire protection system, and a single product solution tested to cover many fire stopping requirements. Featuring ground-breaking technology developed by Nullifire, GXT (Graphite Expansion Technology). For more information visit our website.

- Tested to BS EN 1366-3, up to EI120
- Quick and easy to install: dry, easy to cut and lightweight
- Simple service installation
- Does not detract from the acoustic capabilities of the partition
- Fully breathable, does not absorb moisture



ILLBRUCK PRODUCT RANGE

CY340 MITRE KIT

CY340 is a two part kit comprising of a high viscosity cyanoacrylate adhesive and spray-applied activator. Ideal for rapid bonding of mitred MDF joints during the assembly of valances, pelments and decorative trims. For more information visit our website.

- 2 part kit for instant bonding (< 10 seconds) of wood and wood composite mitre joints
- High viscosity formulation has excellent gap filling properties for irregular or uneven materials
- Spray-applied Activator accelerates curing time and greatly improve bond strength
- Improved bond strength on porous substrates compared to standard cyanoacrylate adhesive



LD925 FLEXIBLE I-SEAL

LD925 is a sprayable, water-based elastic liquid membrane which forms an air seal after drying, with a moisture-variable diffusion resistance. For more information visit our website.

- Water-based so tools are easy to clean
- Airtightness tested by SKG-IKOB to 1750 Pa with a dry layer thickness of 1 mm
- Permanently elastic after curing
- EC1 Plus very low VOC emissions
- Good adhesion to slightly damp surfaces



ME003 VAPOUR BARRIER

ME003 is a 3-ply polyethrane membrane which has been developed as a high performance vapour control layer. The innovative 3-ply polyethylene vapour barrier membrane (VCL) meets virtually all the demands of professional practice. For more information visit our website.

- sd > 107m
- Straightforward application due to low weight
- Flexible and tear-resistant
- Highly vapour retardant
- Compatible with illbruck intelligent window membranes and adhesive



ME010 FACADE UV & FIRE MEMBRANE

ME010 is a water and air tight but vapour permeable polyester based breather membrane – used either as a full façade application or in narrower widths as a window perimeter interface seal. For more information visit our website.

- Class B-s1, d0 to EN13501-1 – fixed to Class A2-s1, d0 mineral wool insulation or sheathing board. Tested with SP025 adhesive as a Fire Classified Membrane System
- High range of in-service temperature resistance
- Highly vapour-open
- Available with self-adhesive strip



ME011 BREATHER MEMBRANE UV

ME011 is a functional membrane for protecting the building during the construction phase and the building fabric throughout its life. For more information visit our website.

- 6 months UV stable during construction phase
- Can be used within partially open facades up to 30mm gap
- Wide range of in-service temperature resistance
- Highly vapour open
- Airtight and weathertight



ME317 INTERNAL MEMBRANE TAPE

ME317 is a single-sided adhesive reinforced paper tape. For the airtight bonding of overlaps in illbruck vapour barrier and membranes for interior use. Also for joints in OSB boards and as an air-seal tape for penetrations. For more information visit our website.

- Fully compatible with all internal illbruck building protection products
- Strong kraft paper
- Easy to tear off by hand
- Quick and easy application



ME501 VV DUO WINDOW MEMBRANE HD

ME501VV is a high strength, tear resistant membrane made from polyethylene copolymer film with non-woven fabric. It can be applied before or after window installation to suit on-site details and programming. For more information visit our website.

- Complies with principle of 'inside tighter than outside' in order to facilitate efficient vapour control
- BBA accredited alternative to EPDM in many applications
- Excellent drying potential avoiding mould growth and physical damage
- UV stable - will tolerate up to 9 months direct exposure prior to covering
- Fully compatible with illbruck building protection membranes



ME508 DUO MEMBRANE EW/F

ME508 is a non-woven fleece laminate which is self adhesive across the full width of the membrane for optimised adhesion. Provides airtightness whilst allowing vapour to diffuse to the exterior of the building.

- Quick and easy application with split release liner
- Initial repositioning possible, bond strength increases over time
- Can be used where wet plaster will be applied
- Helps achieve Passivhaus standards of airtightness



ME904 ADHESIVE TAPE PRIMER

ME904 is used for the pre-treatment of building substrates, e.g. cement particle board, masonry, timber, etc., when using illbruck building protection tapes, particularly for bonding to damp substrates. For more information visit our website.

- Optimises adhesion
- Stabilisation of the surface
- Short drying time
- Solvent free
- Allows use of illbruck building protection tapes in damp conditions



MT480 HIGH GRIP SOLVENT FREE

MT480 is a water-based, gap filling grab adhesive. It offers the same gap filling and bonding performance, but without the issues surrounding solvent-based adhesives. For more information visit our website.

- Water based construction adhesive with high initial grab and ultimate bond strength
- Contains no organic solvents and therefore does not produce any flammable, toxic or objectionable odour vapours
- Gap filling formulation forms a strong bond even with irregular or uneven substrates
- Bond most typical construction material - ideal for expanded and extruded polystyrene



OS111 BITUMINOUS SEALANT

OS111 is bituminous sealant and adhesive that can be applied on damp, wet or submerged substrates. It is ideal for sealing leaks & making repairs even on wet surfaces & can be used for all types of roofing felts. For more information visit our website.

- Can be applied to damp, wet or submerged substrates
- Excellent adhesion
- Ideal for repairing guttering and felt roofs
- Long-term resistance to weathering, ageing and UV



PU700 MULTI-USE CONSTRUCTION ADHESIVE

PU700 is a high-strength adhesive in an innovative delivery system which allows for more accurate application and prevents premature curing. Suitable for bonding a wide variety of materials. For more information visit our website.

- High performance wood and joinery adhesive
- Ideal for bonding a wide range of construction materials including steel and foam
- Rapid curing – joint can be handled / manoeuvred within 10 minutes, and cures fully within 24 hours
- Easy to use: no mixing, no water, no dust, no specialist tools or equipment required



TN119 FLANGE SEAL / ACOUSTIC TAPE

TN119 is a single sided polyethylene foam tape with a fixed film liner on the non-adhesive face. The product comprises a conformable 100% closed cell foam which is coated on one face with a high tack acrylic adhesive. For more information visit our website.

- A quick and easy way to achieve an airtight seal at ductwork connections, ideal for confined areas
- 100% closed-cell PE foam provides an airtight seal even under minimal levels of compression
- Excellent insulation properties against shock, vibration and movement
- Provides a barrier to thermal bridging, galvanic corrosion and acoustic transmission



SP050 FIX AND SEAL UNIVERSAL

SP050 provides a high strength flexible bond in a wide variety of construction and industrial applications. Typical uses include the bonding of skirting boards, battens, slats, door thresholds, acoustic panels (and similar sheet materials), etc. For more information visit our website.

- A more environmentally friendly alternative to traditional polyurethane adhesives
- Excellent adhesion to a wide range of materials including metals, glass, PVC and concrete
- Tack free in less than 30 minutes
- Excellent weather resistance
- Can be over painted once cured



TN553 NON-IMPREGNATED SEALING TAPE P115

TN553 is a single-sided PVC foam tape with high conformability, used as an insulation tape to absorb vibration/ shock, or where an acoustic seal is required. For more information visit our website.

- Highly conformable grade of tape that easily accommodates rough or uneven joint surfaces
- Excellent Insulation performance against shock, vibration and movement
- Provides a barrier to thermal bridging, galvanic corrosion and acoustic transmission



SP150 HIGH TACK HYBRID ADHESIVE

SP150 provides a high strength flexible bond in a wide variety of construction and industrial applications. It is ideal for use in shipbuilding, transportation and modular construction. For more information visit our website.

- A green alternative to traditional polyurethane adhesives.
- Exceptionally high grab and rapid strength build up
- Tack free in approx. 15 minutes
- Excellent weather resistance
- Can be over painted once cured



TP600 COMPRIBAND 600

TP600 is an impregnated joint sealing tape for use in a wide variety of movement joints including window perimeter seals and other applications. For more information visit our website.

- 15 year performance guarantee
- Weather seal for wind-driven rain
- Breathable for vapour diffusion
- Continually expands and contracts to accommodate movement whilst still sealing the joints
- Thermal and acoustic insulation

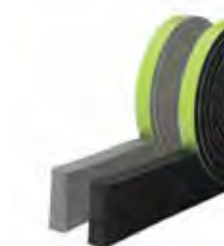

SP510 LOW MOD CONSTRUCTION SEALANT AND ADHESIVE

SP510 is a one component, low modulus construction sealant and adhesive. It cures with air humidity, to form a tack-free surface and provides good resistance to light, ageing and weathering. For more information visit our website.

- Easy to tool
- Good grab properties
- Excellent adhesive
- Free from isocyanates, silicone & solvents
- Low slump



TP601 COMPRIBAND E

TP601 is a weather-retardant, impregnated, open-cell, polyurethane soft foam, enclosed before use in a polypropylene film with a bonding adhesive on one side for fixing. For more information visit our website.

- Factory or site application with activation at any time
- 600 Pa weather resistance
- Applied before frame installation
- No hazardous waste or clean up



SP525 FRAME AND FACADE SEALANT & ADHESIVE

SP525 is a low modulus sealant with high movement capability, excellent primerless adhesion to many substrates and long-term performance. It is also used for the bonding of ME500 & ME501 Intelligent Window Membranes. For more information visit our website.

- Meets the requirements of EN ISO 11600 F 25LM
- High movement, rapid curing and extremely low risk of staining*
- Low modulus formulation ensures minimum stress at joint faces
- High strength bonding of ME500 & ME501 Intelligent Window Membranes



WD120 WOOD ADHESIVE

WD120 is a premium PVA adhesive typically used as in furniture manufacture. Suitable for internal & external applications where resistance to water is required. For more information visit our website.

- Weatherproof PVA adhesive suitable for external use - meets the requirements of EN 204 (D3)
- Can be used in load bearing applications - tested to BS 4071 for creep resistance
- Suitable for RF curing systems, hot and cold pressing and for brush, roller or spray application
- Rapid development of bond with a high final bond strength



SP925 AIR SEAL

SP925 is a one-component, low-viscosity sealant based on hybrid polymer technologies. It is chemically neutral, low odour and is compatible with most common building substrates. For more information visit our website.

- Easy sealing of complex small joints
- Very easy to handle
- Brushable and sprayable
- Permanently elastic



NULLIFIRE PRODUCT RANGE

FF197 GUN GRADE FIRE RATED PU FOAM

FF197 is a modified, single component, fire rated polyurethane foam. FF197 is used to seal door frames, window frames and linear gaps throughout the fire rated areas of a building. For more information visit our website.

- Tested to BS EN 1634-1 (fire door) : FD60 performance achieved
- Gaps up to 35 mm (fire door)
- Tested without architrave (fire door)
- Tested with plastic packers (fire door)
- Tested to BS EN 1366-4 (linear gaps) : up to 4 hours fire resistance



FJ203 FIRE RESISTANT ROPE

FJ203 is used for sealing horizontal and vertical linear joints with or without movement capability between fire resistant separating rigid walls and floors. For more information visit our website.

- Resistance to fire for joints in between rigid walls or floors
- Compensates irregularities in width of a joints
- Fast and easy to cut
- Non combustible



FJ400 INTUSPAN INTUMESCENT JOINT FILLER

FJ400 Intuspan is an extremely compressable, foam based, joint filler. The product is black in colour, and consists of foam layers between high expansion intumescent layers.. For more information visit our website.

- Up to 2 hours fire performance - Tested to BS EN 1366-4 and BS 476 Pt 22
- Ideal for high vibration areas, such as elevator shaft interfaces
- Unaffected by moisture
- Suits vertical & horizontal joints, and head of walls.



FO100 PUTTY PADS

FO100 Putty Pads are an easy to apply fire and sound rated seal supplied as a non-setting putty. The pad is hand workable, re-useable and re-serviceable due to its non-setting properties. For more information visit our website.

- Tested to EN 1366-3:2009, 120 minutes fire resistance in 100 mm and 139 mm dry lining
- Sound insulating BS EN ISO 140-3:1995
- Ready to use – no special tools required
- Cold smoke seal



FP170 INTUCOLLAR INTUMESCENT PIPE COLLAR

FP170 Intucollar comprises of a stainless steel shell and a reactive intumescent lining. FP170 expands when exposed to fire, reinstating the fire performance of compartment walls and floors which have been penetrated by combustible pipes. For more information visit our website.

- Up to 4 hours fire resistance - Tested to EN 1366-3 and EN 1366-4
- Tested for use with combustible pipes, insulated non-combustible pipes, cable bundles and Bevex pipes
- Suitable on flexible & rigid walls, rigid floors
- Easy to install
- Water resistant



FP220 SERVICE SLEEVE

FP220 is a pipe closer device, comprising of an intumescent material within a stainless steel shell. FP220 expands when exposed to fire, reinstating the fire performance of compartment walls which have been penetrated by combustible pipes. For more information visit our website.

- Up to 2 hours fire resistance - tested to EN 1366-3
- Ultra-slim body design ensures easy installation and reduces time on-site
- No fixings required
- Unaffected by moisture
- Simple solution for angled pipes



FP302 INTUMESCENT STRAP

FP302 is designed to close off combustible elements whilst maintaining compartmentation. This product is most commonly used around combustible pipes with a diameter of between 10 mm and 160 mm and all types of pipe insulation up to 60 mm thick. For more information visit our website.

- Unaffected by moisture
- Fully tested for up to 240 minutes integrity and insulation (dependent on application)
- Available in easy to handle rolls
- Simply link with duct tape

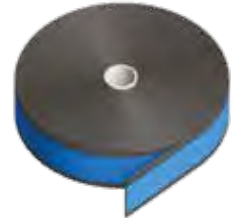

FS702 INTUMASTIC FIRE RESISTANT ACRYLIC SEALANT

FS702 Intumastic is a water-based acrylic sealant which cures to give a firm but flexible fire seal. FS702 has excellent adhesive qualities and can also be used for the bonding and pointing of joints and service penetrations in conjunction with FB750 Intubatt system. For more information visit our website.

- Up to 4 hours fire resistance - Tested to EN 1366-4, EN 1366-3 and BS 476 Pt 20-22
- 30% movement capability (during fire test)
- Acoustics up to 55 dB
- Air seal up to 2,000 Pa



FS703 FIRE RESISTANT SILICONE SEALANT

FS703 is a low modulus, neutral cure, silicone sealant, suitable for linear gaps sealing in order to reinstate the fire performance in compartment walls & floors. For more information visit our website.

- Up to 4 hours fire resistance - Tested to EN 1366-4
- Tested in gaps 10 - 220 mm
- Airtight up to 600 Pa
- Superior elasticity
- UV & weather resistance



FS709 HIGH GRIP SOLVENT FREE

FS709 HP is a high expansion/pressure exerting, graphite intumescent sealant. FS709 expands when exposed to fire, reinstating the fire performance of compartment walls and floors which have been penetrated with services.

- Up to 4 hours fire resistance - Tested to EN 1366-3 and EN 1366-4
- Versatile & easy to apply
- Can be used with FB750 Intubatt Coated Batt
- Tested with combustible pipes up to 125 mm, insulated non-combustible pipes up to 160 mm, cables, cable trays/ ladders/baskets (up to 500 mm), cable bundles (up to 100 mm)



FS719 HP BLUE FOR CPVC

FS719 HP Blue for CPVC is a unique sealant, developed specifically for CPVC materials. The product is a distinctive blue colour, for easy visual identification and traceability. For more information visit our website.

- Up to 2 hours fire resistance - Tested to EN 1366-3
- Versatile & easy to apply
- Can be used with FB750 Intubatt Coated Batt
- Tested in openings up to 365 x 700 mm



TREMCO PRODUCT RANGE

CP150 MMA CONCRETE PRIMER

CP150 is a two component concrete primer, consisting of CP150 Resin and CP510 Initiator. CP500 Filler and CP508 Medium Fine Sand may be added when using as a high build primer. For more information visit our website.

- Fast curing concrete primer which cures in approximately 30 minutes
- Can be applied at temperatures as low as -10°C
- The MMA Coating System can be open to vehicular traffic within 2 hours
- Quick and easy to apply

CP380 RAPID CURE MEMBRANE

CP380 is a heavy duty waterproofing system based on polyurethane modified methacrylates. CP380 is ideal for the repair, renovation and waterproofing of roof systems. CP380 can also be used for the waterproofing of construction details. For more information visit our website.

- 100% waterproof and UV protected
- Very fast curing; 30 minutes at +15°C
- Highest resistance at extremely low and high temperatures (in accordance with ETAG 005)
- Excellent crack bridging performance

SF105 ACRYLIC ADHESIVE FOR PVC AND LINOLEUM

SF105 has been specially developed for linoleum and vinyl floor coverings, particularly the highly plasticised types. It is also approved for use with PVC backed carpets. For more information visit our website.

- Strong initial tack and permanent bond
- Non-flammable
- Good plasticiser migration resistance
- Approved for practically all vinyl (PVC) floor coverings and by most major manufacturers

SF108 PRESSURE SENSITIVE ACRYLIC ADHESIVE

SF108 is a pressure sensitive adhesive for bonding most rubber and vinyl floor coverings as well as vinyl wall coverings. Designed for single stick bonding of rubber flooring, tiles and sheet to porous surfaces and bonding PVC floor, wall and ceiling coverings. For more information visit our website.

- Solvent free and non-flammable
- Guaranteed no serration marks
- Faster application; quicker installation
- Meets existing low VOC requirements

SF110 CARPET ADHESIVE

SF110 is a water based synthetic latex multi-purpose adhesive which has good bond strength and a long open time, is easy to trowel and is non-staining. For more information visit our website.

- Good Initial grab
- Very low VOC
- Long open time
- Clean to use, non-staining



SF165 WATER RESISTANT CONTACT ADHESIVE

SF165 is a cross-linking contact adhesive. SF165 is used for the permanent bonding of: smooth backed rubber floor coverings rubber and PVC nosings covings for service in dry and wet conditions, both indoors and outdoors. For more information visit our website.

- Excellent resistance to plasticiser migration
- Better heat resistance than normal contact adhesives
- Highly resistant to surface water and can be used outdoors
- The bonded floor can be subjected to foot traffic immediately after being placed in position, unlike most other water-resistant adhesives



SX070 FEATHER FINISH COMPOUND

SX070 is a rapid drying feather finish compound for interior applications. Ideal for smoothing and repairing the subfloors prior to the installation of a floor covering. For more information visit our website.

- Short setting and cure time, facilitating a fast track program and minimising disruption
- Can be applied over well bonded thin film adhesive residues
- Can be used to repair ridges and depressions up to 12 mm, or to achieve a true feather edge
- Does not require a primer prior to application



SX302 MOISTURE TOLERANT LATEX UNDERLAYMENT

SX302 is a moisture tolerant cement based latex underlayment. Ideal for use in domestic, light commercial and light industrial environments as an underlayment, prior to application of carpet, wood and vinyl flooring. For more information visit our website.

- May accept foot traffic after approximately 90 minutes
- Moisture tolerant for use under surface damp proof membranes
- Protein free - suitable for use in biologically sensitive areas
- Extremely low odour with no unpleasant ammonia smell



SERVICES

COLLABORATING FOR EFFICIENCY

We work closely with our clients from all aspects of the construction sector to understand their manufacturing processes and performance requirements.

The insight gathered from our experience is combined with our extensive product range to create multi-product solutions that are precisely calibrated to meet your unique needs.

Working With You

Our service is founded on the keystone of collaboration.

To this end, we offer free, on site assessments. These include our assimilation and understanding of your performance objectives, observation of your manufacturing processes and analysis of the products you use. The outcome for you, is manufacturing process enhancements and radical product rationalisations. Along side this, we can offer sustainability and environmental benefits through the reduction of solvent and isocyanate usage, and bulk supply options reducing waste disposal.

Additionally, as our fully integrated product solutions come from one source and achieve better performance levels with fewer products, we can offer considerable logistic and supply chain improvement

Research and Development

With 6 technology innovation hubs across Europe, we seek to combine market insights with production know-how and research expertise to produce products and systems that make the lives of our customers easier. We have a track record for delivering innovations which simplify installations processes, are quicker to use and offer enhanced performance levels.

We value local user involvement in our development activities and seek to capture customer insights through workshops and end user testing in the field.

Quality Guaranteed

All our production plants are certified:

- ISO 9001: Internal organisation & efficiency
- ISO 14001: Environmental impact reduction
- BS OHSAS 18001: work and health safety

Our products are tested to the relevant European and British standards and where appropriate carry CE marking.

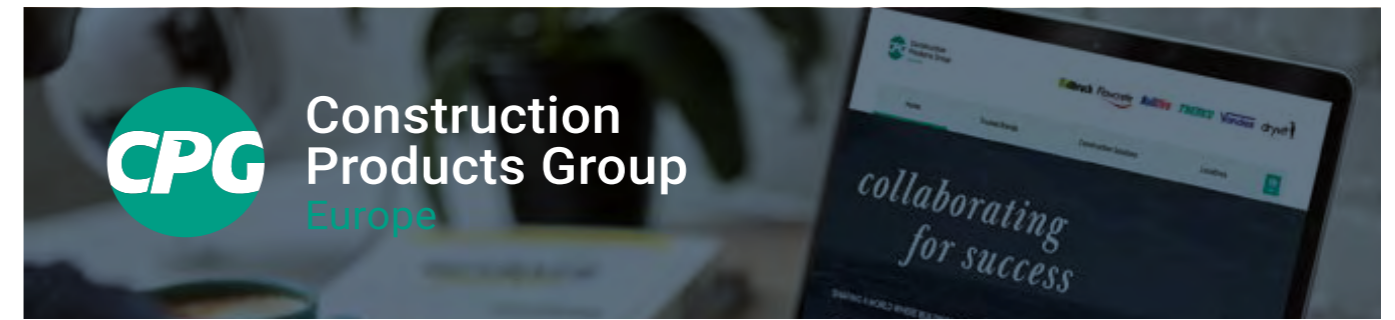

CPG Europe manufactures high performance building materials in order to solve the complex challenges faced by today's construction industry. With over 1,400 employees across Europe, we are committed to shaping a world where buildings and structures save energy, last longer and exceed sustainability benchmarks.

Delivering World-Class Construction Product Solutions.

The product brands housed within CPG Europe cover a wide array of different construction needs and provide a wealth of complex services, support and systems that are rarely found together under one roof.



Sealing, bonding & insulation

Window Insulation, Façade Construction, Exterior Insulation & EIFS, Structural & Inplant Glazing



Passive fire protection

Intumescent Coatings, Fire Stopping



Flooring

Seamless Resin Flooring, Subfloor Preparation, Car Parking Structures



Waterproofing

Civil Engineering, Potable & Waste Water Industry, Balconies, Terraces, Basements & Foundations

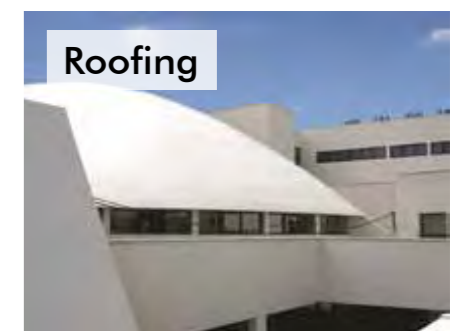

Roofing

Liquid Applied Systems, Felt Systems, Vegetated Roofing

Europe's leading construction products brands...



trusted brands

COLLABORATING FOR SUCCESS

Tremco CPG UK Ltd
Coupland Road, Hindley Green
Wigan WN2 4HT UK

www.cpg-europe.com
+44 (0) 1942 251400
sales.uk@cpg-europe.com

