



DuraPass
Personnel doors



DuraPass
THERMA+ Personnel Doors

U Value
1.4



DuraPass
Fire Personnel Doors



NEW!
FD30 & FD60
fire personnel doors
- U-Value 1.6 W/m²K



Steel Door Solutions



EN 14351-1



modular & portable
building association



Raising Standards
Safety Assured

Steel Doors designed & built to the ideal requirements of your sector

The Pass door is a brilliant solution for access to your external building - a good looking, high performance entry door.

Inspiring confidence & trust

- Manufactured in the UK.
- Fast turnaround and delivered throughout the UK & Ireland.
- CE marked, certified product.
- Innovation award winner with Patented design.
- **ERA** Multi-point locking.
- **Therma+** personnel doors Part L compliant - U-values as low as 1.3 W/m²K!
For full details, see pages 8 - 9.
- **NEW!** FD30 & FD60 fire personnel doors - U-values as low as 1.6 W/m²K!
For full details, see pages 10-11.



DuraPass
Fire Personnel Doors



U-Value
1.6 W/m²K



DuraPass
Personnel doors

U-Value
1.9 W/m²K



DuraPass
THERMA+ Personnel Doors

U Value
1.4

U-Value
1.4 W/m²K



Steel Buildings



Modular Buildings

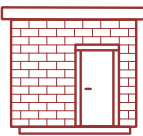

External Garages



Flush in
Goosewing Grey



Linear Medium in
Anthracite

PDS strongly recommends a <5mm tolerance between finished opening size and over-frame (order) size to prevent frame distortion which will affect performance.

Fully finished colours



Colour

Choose a finish from our standard colour palette:

Standard Colours

WHITE RAL 9016	BLACK RAL 9005	ANTHRACITE RAL 7016	GOOSEWING GREY RAL 080 70 05	OLIVE GREEN BS 12 B 27	JUNIPER GREEN BS 12 B 29
-------------------	-------------------	------------------------	------------------------------------	---------------------------	-----------------------------

Colours shown are for guide purposes only and are limited by the printing process. Always request to see a finish sample for confirmation of colour.

RAL numbers are provided as the nearest approximation to the colour and will not match precisely.



For FD30 & FD60 colour range, please see page 10.



Stainless steel is also available for aesthetics or clean environment applications - talk to us about your requirements.



Linear Large
in White

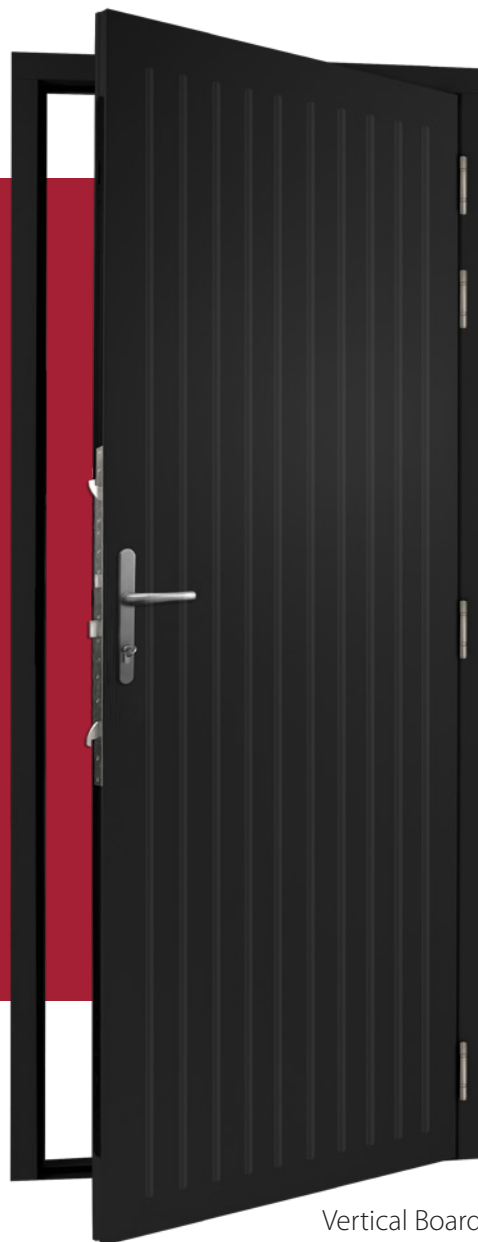

Vertical Board
in Black

Feature file – Award winning innovation

Dependable security

The dead bolt locking with twin hook latches and four security-pinned stainless-steel hinges per leaf provide robust, dependable security. 8 point locking is the result – 4 security pinned hinges plus the ERA lock's twin hook latches, latch and mortice.

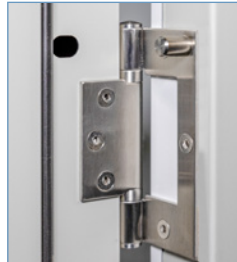

Durable, stylish security

The corrosion resistant stainless steel handle, lock, strike plate and hinges provide attractive and durably finished secure access.

3 keys as standard

Supplied with 3 keys and a Euro-profile cylinder as standard. Replacement keys can be duplicated from a standard blank at any locksmith.



Clever design

No rivets or welds to the front face of the door and colour matched frame as standard.



Lightweight construction

The door is inherently strong and rigid, yet lightweight. 45kg for a single leaf door and frame is typical, making handling easier and safer.

Low profile

Standard low-profile threshold with weatherseal makes it easy to move any wheeled item in or out. Open-in or open-out options. Thresholds available to meet the requirements of The Equality Act, Building regulations Part M and BS 3800.

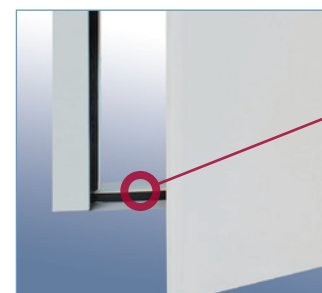

Drip tray

The threshold includes an integral drip tray to help reduce water ingress.



PDS strongly recommends a <5mm tolerance between finished opening size and over-frame (order) size to prevent frame distortion which will affect performance.

8
LOCKING
POINTS



Pass door -
inside view

U-Value 1.9 W/m²K
Pre-framed doorsets

The rear face of the door panel on all standard colours is finished in a soft-white light reflecting finish. The frame will match the finish of the front face. The contrast between door leaf and frame assists with EA compliance for Visual Contrasts and Light Reflective Values (LRV).

Shown above is a Goosewing Grey door from the inside - White inner face, Goosewing Grey Frame.

Built to Last



Extra strength

Doors are pre-framed with four stainless steel hinges, two of which are security-pinned.



Smart fit frame options

The Smart Fit colour-matched frame options (Standard, Odd-Leg & Flange) enable fast installation and require minimal finishing following installation.

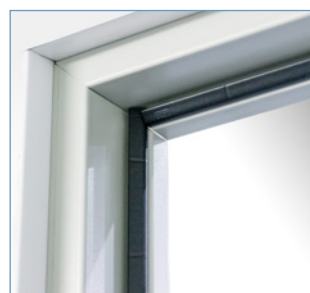

All round weather seals

Q-Lon seals run around the inside of the door frame to help prevent water ingress around the door.

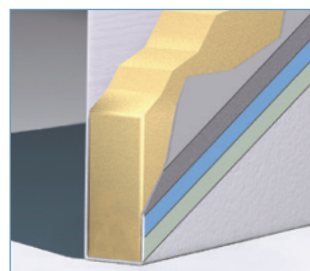

Available in Part-L compliant U-value 1.4 W/m²K! See pages 8 - 9.

44mm Insulated door

44mm insulated panel in exterior grade steel is factory coated and provides enhanced weather-beating performance - U-Value 1.9 W/m²K.



Seal strip

Inward opening doors include a threshold and seal strip onto which the door leaf closes. This helps to reduce water ingress under the door leaf, further assisted by an integral drip tray.



NEW!
FD30 & FD60
fire protection!
See pages 10 - 11.

Double doors



Double doors are available in a range of standard sizes with 50:50 or asymmetric (off-centre) as shown below.

- Available as open-out.
- 14-point locking as standard.
- 6 standard fully finished colours – See page 3.
- Available in Part-L compliant U-value 1.4 W/m²K! **See pages 8 - 9.**
- Minimum over-frame width 1585mm / Maximum over-frame width 2300mm
- Minimum over-frame height 1785mm / Maximum over-frame height 2300mm

14
LOCKING
POINTS

U-Value 1.9 W/m²K
Pre-framed doorsets



PDS strongly recommends a <5mm tolerance between finished opening size and over-frame (order) size to prevent frame distortion which will affect performance.

Feature file

Many features of DuraPass double leaf doors are shared with the single leaf door shown on the previous pages. Below are additional and selected features.



Security Guard



Built to Last



Double door inactive leaf

Option 1.

The inactive leaf is secured with a shoot bolt at the top (surface mounted for easy maintenance) and also has a robust foot operated shoot bolt to secure the door leaf at the bottom.

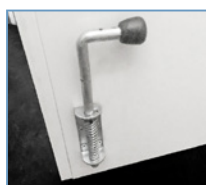
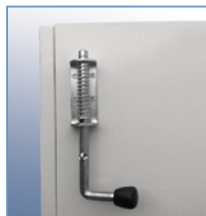

Option 2.

The inactive leaf can also be secured at the top and bottom with robust heavy duty spring loaded shoot bolts.

Secure

The dead bolt locking with twin hook latches protected with an anti-jemmy strip (on outward opening doors) and four security-pinned stainless-steel hinges per leaf provide robust, dependable security. 14 point locking is the result – 8 security pinned hinges, twin shoot bolts to the passive leaf plus the ERA lock's twin hook latches, latch and mortice.

Security Guard



Low profile threshold

Standard low-profile threshold with weatherseal makes it easy to move any wheeled item in or out. Threshold options are available to meet the requirements of The Equality Act, Building regulations Part M and BS 3800.

Extra Easy

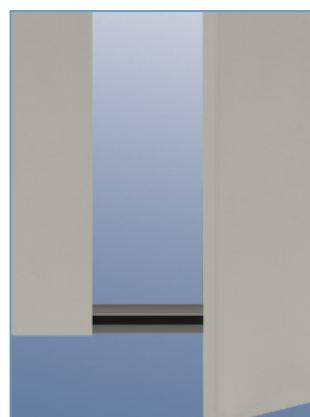

White inner door face

The rear face of the door panel on all standard colours is finished in a soft-white light reflecting finish. The frame will match the finish of the front face. The contrast between door leaf and frame assists with EA compliance for Visual Contrasts and Light Reflective Values (LRV).

Pass door - inside view

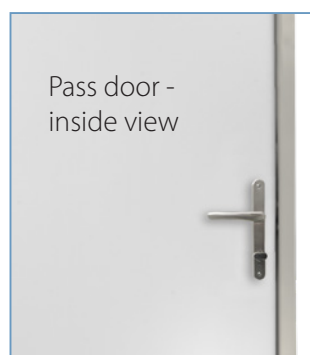

Shown above is a Goosewing Grey door from the inside - White inner face, Goosewing Grey Frame.

THERMA+



DuraPass
THERMA+ Personnel Doors

U Value
1.4

Single & double doors

2022 changes to building regulations contain requirements relating to the conservation of fuel and power. They set higher standards for the energy performance and carbon emissions of new and existing buildings.

Pass Doors' DuraPass Doorsets help you meet the new regulations and support the drive for Net-Zero.

DuraPass Therma+ Doors are compliant with Part L of the latest building regs for U-Values in both England (1.6) & *Scotland (1.4)

*Effective from February 2023

Feature file

- Available as a single or double door.
- 8-point locking as standard on single doors and 14-point locking as standard double doors.
- Double doors are available in a range of standard sizes with 50:50 or asymmetric (off-centre).
- 6 standard fully finished colours – See page 3.
- Single doors are available open-out or open in. Double doors are available as open out only.
- Manufactured in the UK.
- Fast turnaround and delivered throughout the UK & Ireland.
- CE marked, certified product.
- Innovation award winner with Patented design.
- **ERA** Multi-point locking.

Doors with vision panels

Therma+ is available with vision panels. DuraPass Therma+ 74mm leaf doorsets have 250mm x 1200mm triple glazed argon filled units with warm edge spacers and climaguard glass that have been tested to achieve Part L compliant U Values as low as 1.3.

U Value
1.3



PDS strongly recommends a <5mm tolerance between finished opening size and over-frame (order) size to prevent frame distortion which will affect performance.

8
LOCKING
POINTS

1
Year Warranty
COMMERCIAL USE

CE
EN 14351-1
ERA®

14
LOCKING
POINTS

U-value 1.4 W/m²K

Weather
Shield

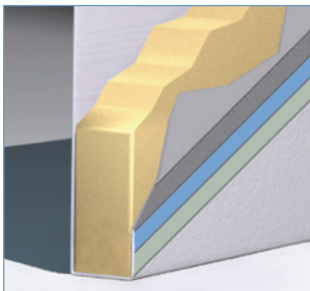

54mm Insulated door

54mm insulated panel in exterior grade steel is factory coated and provides enhanced weather-beating performance - U-Value 1.4 W/m²K.

NET
ZERO



Helping you meet the new Part L regulations & support the drive for Net-Zero.

FD30 & FD60



DuraPass
Fire Personnel Doors



5
LOCKING
POINTS

Fire personnel doors

NEW! DuraPass fire personnel doors offer FD30 or FD60 fire protection combined with excellent thermal properties.



Achieves 30 or 60 minutes (E) integrity rating tested to BSEN1634-1 and classified under BS EN13501-2.



Compliant with Part L of the latest building regs for U-Values in England 1.6 W/m²K.

Feature file

- Available in single and double doors.
- 54mm door leaf.
- Standard 5 point locking on single doors and 11 point locking on double doors.
- Stainless steel lever handle.
- Fitted with Hoppe security pinned hinges.
- Intumescent seals.
- Certified **ARRONE** mortice locks and the AR5500 EN2-5 door closer as standard.
- Available open in/out on single doors and open out only on double doors.
- Manufactured in the UK.
- Fast turnaround and delivered throughout the UK & Ireland.
- CE marked, certified product.
- Innovation award winner with Patented design.

Options:

Panic functions

Optional BS EN 179 and BS EN 1125 panic functions available.



Vision panels

DuraPass fire personnel doors are available with fire rated double glazed 250mm x 550mm vision panels - See page 15 for all vision options.

Glazed doors U-value 1.8 W/m²K.

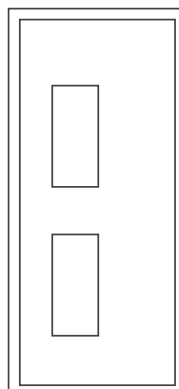

2 x 250mm x 550mm

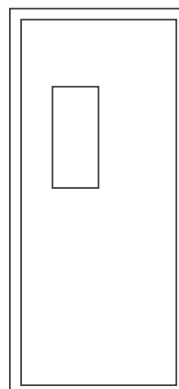

1 x 250mm x 550mm

Colour

Choose a finish from our standard colour palette:

Standard Colours

WHITE RAL 9016	BLACK RAL 9005	ANTHRACITE RAL 7016	GOOSEWING GREY RAL 080 70 05
-------------------	-------------------	------------------------	------------------------------------

Colours shown are for guide purposes only and are limited by the printing process. Always request to see a finish sample for confirmation of colour. RAL numbers are provided as the nearest approximation to the colour and will not match precisely.



Fitting tolerance must be 5mm or less and all installation instructions strictly followed to maintain fire rated door integrity.

11
LOCKING
POINTS



LOW U-VALUE FIRE DOOR

U-value
 $1.6 \text{ W/m}^2\text{K}$

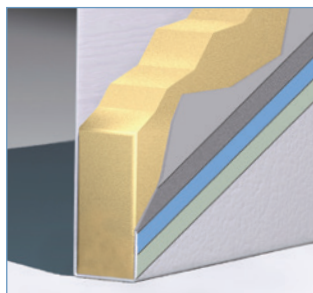

54mm Insulated door

54mm insulated panel with Fabrock infill in exterior grade steel is factory coated and provides enhanced weather-beating performance - U-Value $1.6 \text{ W/m}^2\text{K}$ on unglazed doors.



NET
ZERO

Helping you meet the new Part L regulations & support the drive for Net-Zero.

Frames

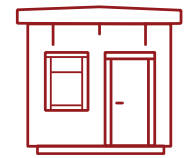

Modular Buildings

 **Available on fire doors!**

70mm/80mm Odd Leg Frame Designed for modular, the odd leg frame is quick to install and requires minimal finishing for a neat installation, inside and out. Available in both open out or open in variants. 70mm for DuraPass and 80mm for DuraPass Therma+.



Steel Buildings

70mm (40-65mm) Variable Flanged Frame Designed for steel buildings, the flanged frame is available to suit standard steelwork profiles. Available in both open out or open in variants.

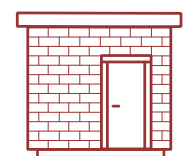
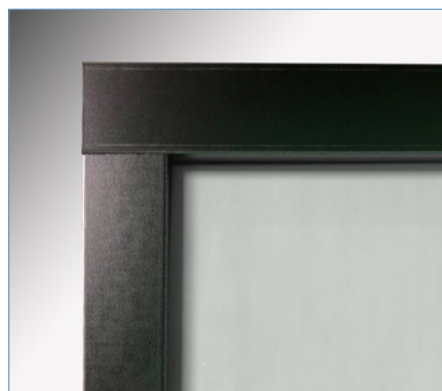

External Garages

 **Available on fire doors!**

70mm Standard Frame The standard frame is versatile and quick to install. Available in both open out or open in variants.

PDS strongly recommends a <5mm tolerance between finished opening size and over-frame (order) size to prevent frame distortion which will affect performance.

Panic hardware



Available on
fire doors!



EN 1125 - panic applications

The main purpose of the performance requirements of this standard is to give safe and effective escape through a doorway with minimum effort and without prior knowledge of the device.

EXIDOR

296 Single Panic Push Bar Single Latch

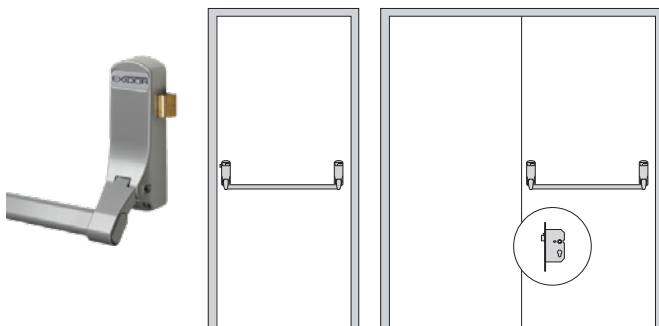

285 Double Panic Push Bar with Single Latch
& 2 Point Bolt

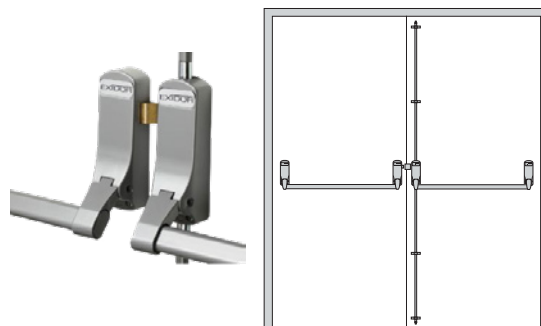

EN 179 - panic applications

This standard covers devices to be used in emergency situations where people are familiar with the emergency exit and its hardware and therefore a panic situation is most unlikely to develop.

EXIDOR

297 Push Pad Single Latch

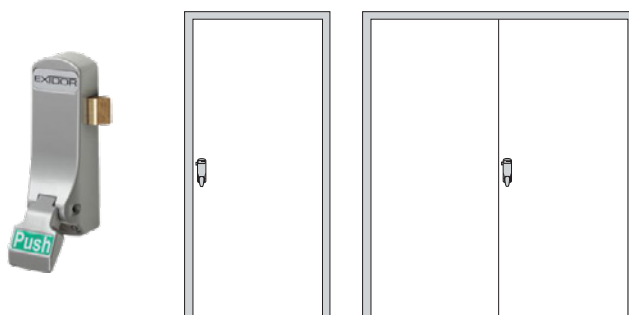

322EC Lever Operated Outside Access Device

The 322EC works with the 296, 285 and 297 push bars/pad (above).



EXIDOR

CL500 Code Lock

Option 1 - CL500 Code Lock with Exidor Push Pad

The CL500 Code Lock works in conjunction with the Exidor 297 Push Pad as shown.

Option 2 -CL500 Code Lock with CL525 Mortice Lock

CL500 that incorporates an internal handle and can be used for open-in scenarios.

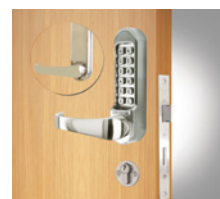

Works with

EXIDOR

Closers

 **Available on fire doors!**



Reinforcing Plates for Closers

Doors, when ordered with a closer, are prepared with reinforcing plates and nutserts for ease of installation.

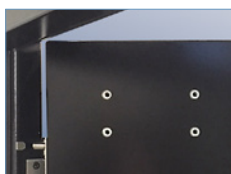

Arrone AR5200 Heavy Duty Closer

Spring Power Adjustable Overhead Closer

- Adjustable power size 2 - 5
- Backcheck facility
- Slide Cover
- CE Marked to EN 1154



Carlisle Brass CDG003 Medium Duty Closer

Fixed Power Compact Overhead Closer

- CE Marked to EN 1154
- EN Power 3
- Adjustable closing speed and latch action



Arrone AR5500 Fire Door Closer



Universal Application Overhead Closer

- Fire tested for use on up to 240 minute steel fire doors
- Adjustable power size 2 - 5
- Backcheck facility
- CE Marked to EN 1154



Options

Finger protection strips

Finger protection strips are anti-trapping devices that protect children's fingers at the most dangerous side of the door: the hanging side.



Door are available with a thumb turn as an option.

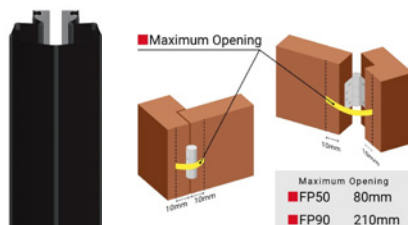

National Key Scheme

Door are available with a National Key Scheme lock set that can only be operated by using special NKS or RADAR keys.



Rain deflectors & rain guards

Rain deflectors are available as an option fitted to the bottom of the door deflecting water from the threshold seal, reducing the risk of water ingress.

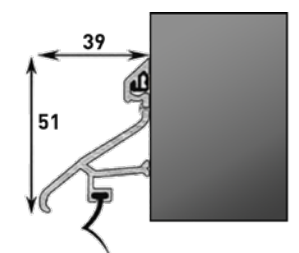

Rain guards are available as an option fitting to the top of the door to help repel moisture and wind-driven rain infiltration.

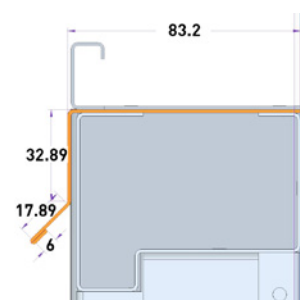

PDS strongly recommends a <5mm tolerance between finished opening size and over-frame (order) size to prevent frame distortion which will affect performance.

Vision panels



 **Available on fire doors!**



Clear Glass or Georgian Wired (GWPP) in toughened safety glass (Glass ABS 6206: 1981)

People should be able to view others approaching or standing either side of a door to avoid the risk of collision. (There may be circumstances where for reasons of privacy or security this may not be appropriate or possible).

The diagram below shows the minimum requirements to satisfy Part M. (Please note that this diagram is now shown in Part K of the Building Regulations, not Part M. It is referenced in Part M).

For **Therma+** window options, see page 8.



For **DuraPass fire personnel** window options, see page 10.

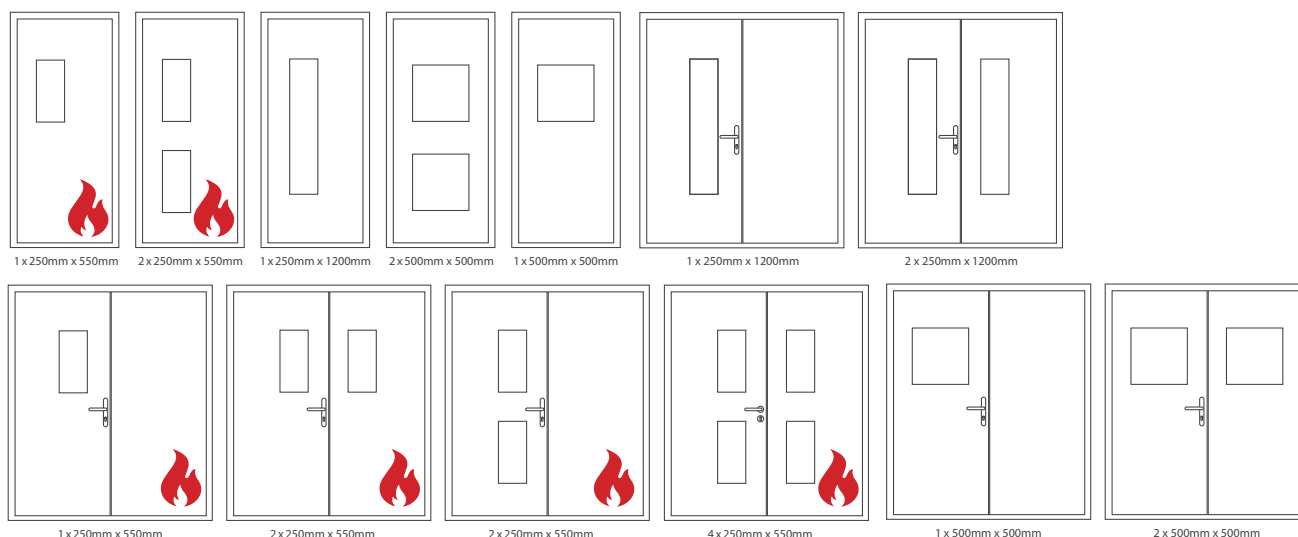
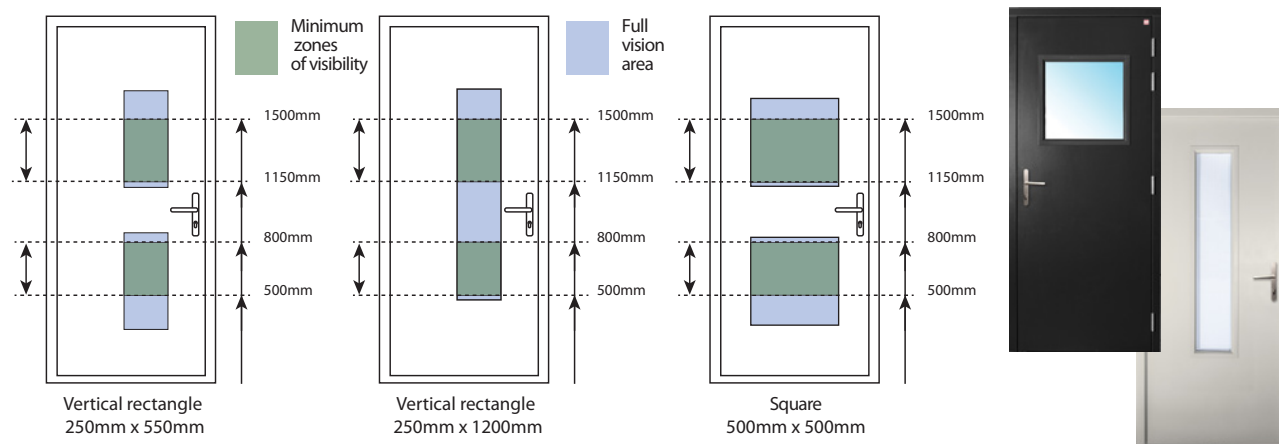

The best performance for your door

The area within the arc of the door's swing must be level or falling away to ensure the door can open unhindered.

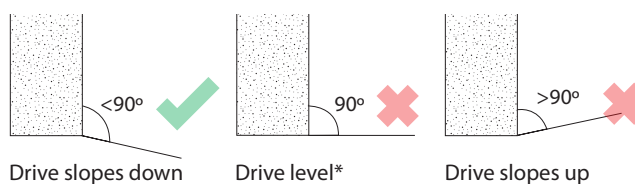
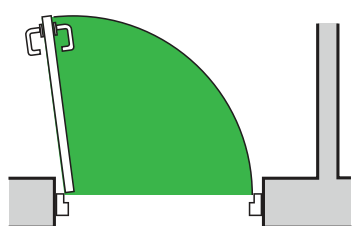

*Susceptible to water pooling and ingress unless a full-length drainage grate is present in front of the door.



Pass Door Systems is a specialist external doors manufacturer for Modular / Steel Sheds and external building companies throughout the UK & Ireland.



Steel Buildings



Modular Buildings

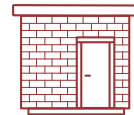

External Garages



- Industry popular sizes and made to measure options
- Excellent lead times from our highly automated facilities
- Full UK and Ireland service
- Proudly made in Ballymena (UK)



Proud to be a member of...



modular & portable building association



Raising Standards
Safety Assured



DuraPass
Fire Personnel Doors



FD30 & FD60
fire personnel doors
- U-Value 1.6 W/m²K

See pages 10 - 11!



Pass Door Systems Wakehurst Ind. Est.,
Ballymena, BT42 3AZ

T: +44 (0) 28 25 44 69 30

E: info@passdoorsystems.com

Web: www.passdoorsystems.com

Pass Door Systems operates a policy of continuous product development and reserves the right to alter specifications to product design features, product functionality, other product specifications and product manufacture without notification. All specifications are correct at time of publication, errors and omissions excepted. Date 03/25 Issue 1. Colours shown are for guide purposes only and are limited by the printing process.



PassDoor 03/25